

# LX

Levelling elements

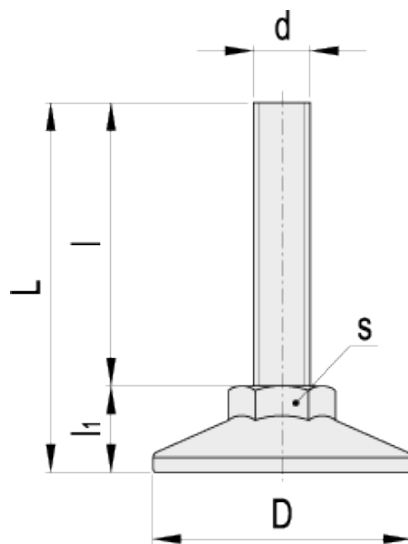

#### technical informations

##### Base

Polyamide based (PA) technopolymer with adjusting hexagon. Resistant to solvents, oils, greases and other chemical agents.

##### Colour

Black, matte finish.

##### Stem

Threaded zinc-plated steel.

Standard Elements		Main dimensions						Max limit static load*	Weight
Code	Description	D	d	l	L	l <sub>1</sub>	s	[N]	g
431001	LX.25-SW13-M6x24	25	M6	24	35	11	13	1500	75

431003	LX.25-SW13-M6x34	25	M6	34	45	11	13	1500	77
431005	LX.25-SW13-M6x54	25	M6	54	65	11	13	1500	86
431007	LX.25-SW13-M6x62	25	M6	62	73	11	13	1500	88
431011	LX.25-SW13-M8x17	25	M8	17	28	11	13	2500	82
431013	LX.25-SW13-M8x22	25	M8	22	33	11	13	2500	87
431015	LX.25-SW13-M8x32	25	M8	32	43	11	13	2500	91
431017	LX.25-SW13-M8x52	25	M8	52	63	11	13	2500	105
431019	LX.25-SW13-M8x72	25	M8	72	83	11	13	2500	120
431031	LX.40-SW17-M8x12	40	M8	12	25.5	13.5	17	2500	127
431033	LX.40-SW17-M8x20	40	M8	20	33.5	13.5	17	2500	133
431035	LX.40-SW17-M8x30	40	M8	30	43.5	13.5	17	2500	137
431037	LX.40-SW17-M8x50	40	M8	50	63.5	13.5	17	2500	151
431039	LX.40-SW17-M8x70	40	M8	70	83.5	13.5	17	2500	167
431041	LX.40-SW17-M10x20	40	M10	20	33.5	13.5	17	3000	144
431042	LX.40-SW17-M10x30	40	M10	30	43.5	13.5	17	3000	155
431043	LX.40-SW17-M10x40	40	M10	40	53.5	13.5	17	3000	165
431044	LX.40-SW17-M10x50	40	M10	50	63.5	13.5	17	3000	185
431045	LX.40-SW17-M10x60	40	M10	60	73.5	13.5	17	3000	198
431046	LX.40-SW17-M10x70	40	M10	70	83.5	13.5	17	3000	206
431049	LX.40-SW17-M10x100	40	M10	100	113.5	13.5	17	3000	295

\* The max static load is the value above which the load applied to the element may cause some plastic material breakage, in particular conditions of use. Obviously, a factor that takes into consideration the importance and the safety level of the specific application must be applied to this value.



ELESA-GANTER models all rights reserved in accordance with the law. Always mention the source when reproducing our drawings.

**STANDARD MACHINE ELEMENTS WORLDWIDE**