



GN 4490

Ball catches



Specification

Identification no.

- No. **1**: standard holding force
- No. **2**: high holding force

Zinc die casting **ZD**

plastic coated

black, RAL 9005, textured finish **SW**

silver, RAL 9006, textured finish **SR**

Ball

Stainless Steel A2

Spring

Stainless Steel AISI 301

Ball guide

Plastic

Information

Ball catches GN 4490 are used, for example, to hold flaps and doors closed that must be opened and closed frequently and easily.

They consist of a ball housing and a retaining element that engages in the ball housing from the side or front. The installation orientation can be chosen as desired.

Beyond the typical uses, these solid and attractively designed ball catches are also utilized in technical environments. For example, thanks to the centered 90° countersunk holes, they can also be used with profile systems.

Technical information

- [Stainless Steel characteristics](#)

On request

- other colors
-

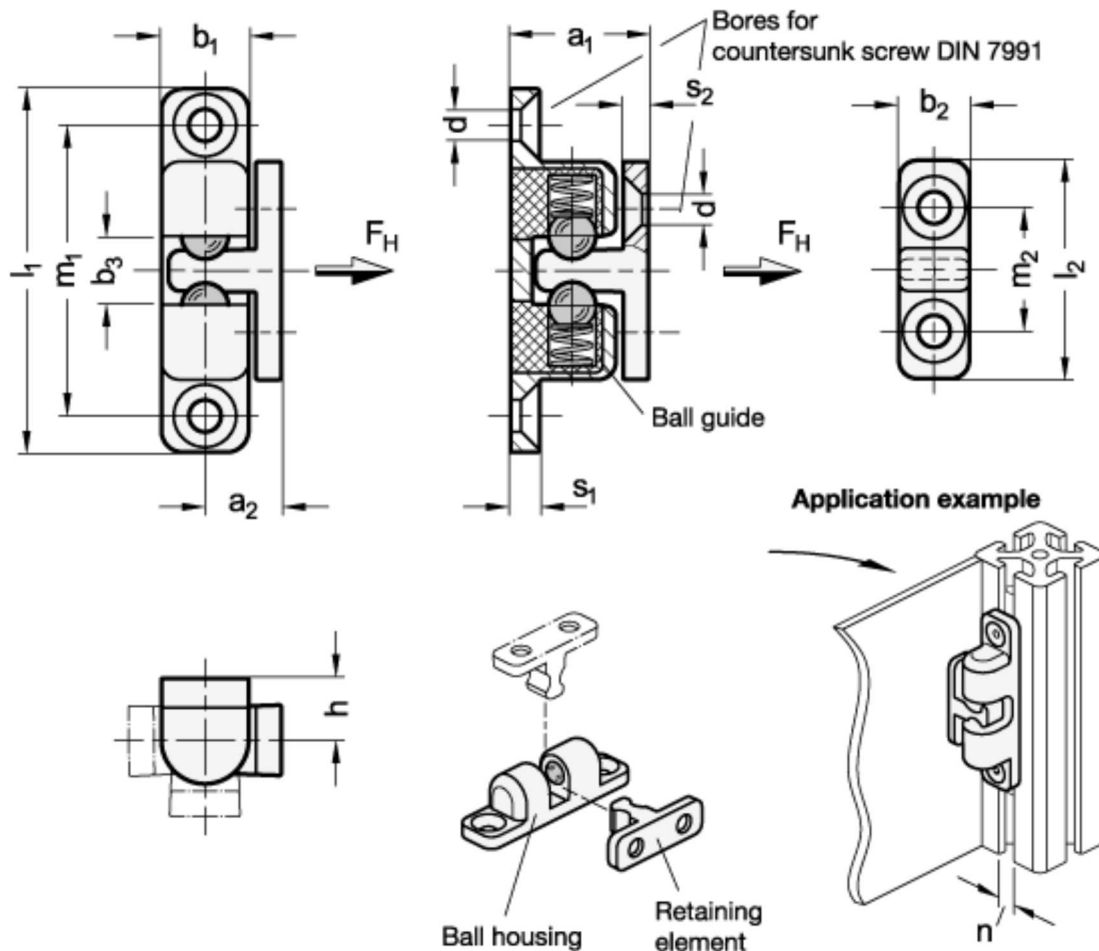

- Black (RAL 9005) Black
- Silver (RAL 9006) Silver

GN 4490

Description	l_1	a_1	a_2	b_1	b_2	b_3	d	h	l_2	m_1	m_2	s_1	s_2	for nut width n	Holding force FH in N	Weight
GN 4490-ZD-38-1-SW	38	15	7.5	8	7	4.3	M3	7.5	21	30	12	4	2.5	≤ 4.5	25	12
GN 4490-ZD-38-1-SR	38	15	7.5	8	7	4.3	M3	7.5	21	30	12	4	2.5	≤ 4.5	25	12
GN 4490-ZD-38-2-SW	38	15	7.5	8	7	4.3	M3	7.5	21	30	12	4	2.5	≤ 4.5	35	12
GN 4490-ZD-38-2-SR	38	15	7.5	8	7	4.3	M3	7.5	21	30	12	4	2.5	≤ 4.5	35	12
GN 4490-ZD-50-1-SW	50	20	10.5	12	10	6.5	M4	9.5	30	40	17	5	3.5	≤ 6	30	31
GN 4490-ZD-50-1-SR	50	20	10.5	12	10	6.5	M4	9.5	30	40	17	5	3.5	≤ 6	30	31
GN 4490-ZD-50-2-SW	50	20	10.5	12	10	6.5	M4	9.5	30	40	17	5	3.5	≤ 6	55	31
GN 4490-ZD-50-2-SR	50	20	10.5	12	10	6.5	M4	9.5	30	40	17	5	3.5	≤ 6	55	31
GN 4490-ZD-68-1-SW	68	23	12	14.5	11	9.5	M4	11	32.5	55	20	5	3.5	≤ 8	50	55
GN 4490-ZD-68-1-SR	68	23	12	14.5	11	9.5	M4	11	32.5	55	20	5	3.5	≤ 8	50	55
GN 4490-ZD-68-2-SW	68	23	12	14.5	11	9.5	M4	11	32.5	55	20	5	3.5	≤ 8	70	55
GN 4490-ZD-68-2-SR	68	23	12	14.5	11	9.5	M4	11	32.5	55	20	5	3.5	≤ 8	70	55
GN 4490-ZD-80-1-SW	80	27	14	16.5	13	11	M5	13	40	65	25	6	4	≤ 10	95	88
GN 4490-ZD-80-1-SR	80	27	14	16.5	13	11	M5	13	40	65	25	6	4	≤ 10	95	88
GN 4490-ZD-80-2-SW	80	27	14	16.5	13	11	M5	13	40	65	25	6	4	≤ 10	125	88
GN 4490-ZD-80-2-SR	80	27	14	16.5	13	11	M5	13	40	65	25	6	4	≤ 10	125	88