

WIRE ROUTING, CLIPS AND CLAMPS

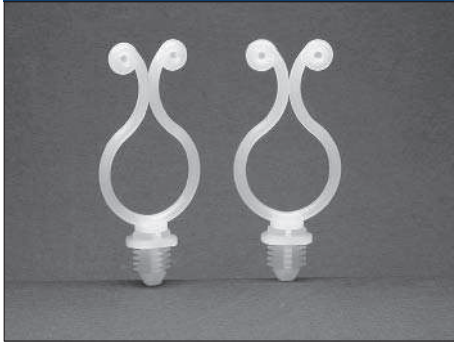

BHKL

BLIND HOLE KURLY LOCK

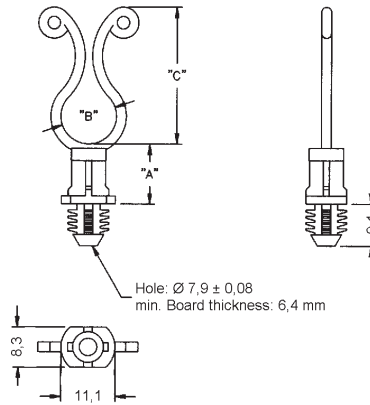

Part No.	"A" mm	"B" ø mm	"C" mm
BHKL350-4-01	6.4	7.6 - 10.2	25.4
BHKL350-6-01	9.5		
BHKL350-8-01	12.7		
BHKL350-10-01	15.9		
BHKL450-4-01	6.4	10.2 - 12.7	28.6
BHKL450-6-01	9.5		
BHKL450-8-01	12.7		
BHKL450-10-01	15.9		
BHKL750-4-01	6.4	17.8 - 20.3	38.1
BHKL750-6-01	9.5		
BHKL750-8-01	12.7		
BHKL750-10-01	15.9		

UL N° E71558

Note:

BHKL	750	6	01
Part	Type	Size	Material Code

Material: Nylon 6/6 - natural, UL 94 V-2, RMS-01
or
Nylon 6/6 - natural, UL 94 V-0, RMS-19
Std. Pk.: 1.000 pcs.

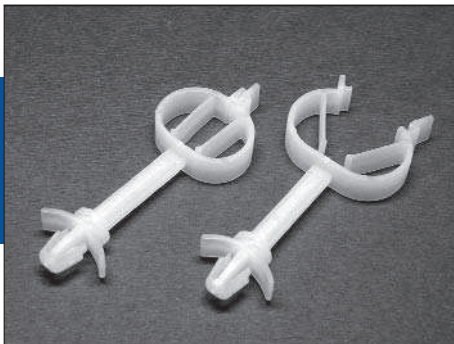

WSHK-J

WEBBED STANDOFF HARNESS CLIP

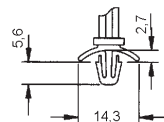
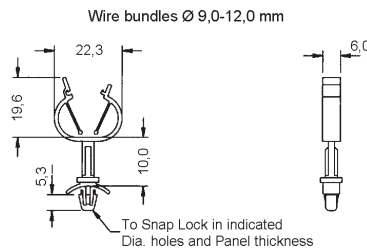

Hole: Ø 4,8 ± 0,08
Board thickness: 1,6 mm

WSHK-J

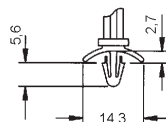

Hole: Ø 4,0 ± 0,08
Board thickness: 1,6 mm

WSHK-J1

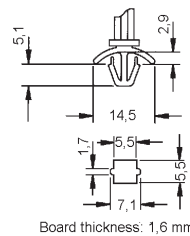

Board thickness: 1,6 mm

WSHK-J2

Note:

WSHK	J	01
Part	Head style	Material Code

Material: Nylon 6/6 - natural, UL 94 V-2, RMS-01
or
Nylon 6/6 - natural, UL 94 V-0, RMS-19
Std. Pk.: 1.000 pcs.